

NEW/EXISTING BLDG JUNCTION PLAN DETAIL
SCALE: 3/4" = 1'-0"

- FIRE ALARM DEVICE SCHEDULE**
- G.C. TO LOCATE CENTRAL CONTROL STATION
 - INSTALL WALL MTD PORTABLE FIRE EXTINGUISHERS IN LOCATIONS SHOWN AND PER OBC 812.2.1 NFPA 12 OR PER LOCAL FIRE MARSHAL INSPECTION
 - FIRE ALARM SUBCONTRACTOR TO LOCATE ALL SMOKE DETECTORS PER CODE, WIRE & ZONE PER OBC
- FE FIRE EXTINGUISHER EXPOSED MOUNT
 FE FIRE EXTINGUISHER SEMI RECESSED CABINET & ACRYLIC DR
 KA STROBE ALARM
 HA HORN ALARM
 CA COMBINATION HORN/STROBE ALARM
 P.S. FULL STATION #44 AFF. MOUNT 8" FROM DR JAMB

- WALL SCHEDULE**
- 5/8" TYPE 'X' GIBB BOTH SIDES ON 3 5/8" 20GA MTL STUDS @ 16" O.C. GIBB TO EXTEND TO CLG DECK (9'-4" AFF. TO TOILETS)
 - SAME AS #1 W/FULL 6" ACOUSTICAL BATTS, FULL HT
 - INSTALL ON 2" 20GA MTL STUDS @ TOILET CHASE WALLS
 - 5/8" TYPE 'X' GIBB TO 6" ABOVE CLG ON EXTG STUDS @ END PANEL
- NOTE: ALL EXTERIOR WALLS TO BE 6" 20GA MTL STUDS, UNO. SEE SECTIONS ON SHT A-1

DOOR SCHEDULE

DOOR MARK	DOOR SIZE	THICKNESS	MATERIAL FINISH	MATERIAL	FINISH	FRAME	FINISH	SILL (HANDICAP ACCESSIBLE)	FIRE RATING	REMARKS
1	DBL 6'-0" x 1'-0"	1 3/4"	ALUM.	DB.	ALUM.	DB.	ALUM.	ALUM.	A	FULL LITE MEDIUM STILE KAINEER 192 W/450 SIDELITES. 12" UNIT WIDTH
2	DBL 6'-0" x 1'-0"	1 3/4"	ALUM.	DB.	ALUM.	DB.	ALUM.	ALUM.	B	FULL LITE MEDIUM STILE KAINEER 192 W/450 SIDELITES. 12" UNIT WIDTH
3	DBL 6'-0" x 1'-0"	1 3/4"	9C/AUD	STAIN	9C/AUD	STAIN	9C/AUD	STAIN	B	FULL LITE MEDIUM STILE 4 FRAME
4	DBL 6'-0" x 1'-0"	1 3/4"	9C/AUD	STAIN	9C/AUD	STAIN	9C/AUD	STAIN	B	FULL LITE MEDIUM STILE 4 FRAME
5	3'-0" x 6'-8"	1 3/4"	HM.	PAINT	HM.	PAINT	HM.	PAINT	E	FLUSH & FURNACE CLOS.
6	3'-0" x 6'-8"	1 3/4"	HM.	PAINT	HM.	PAINT	HM.	PAINT	E	FLUSH & FURNACE CLOS.
6A	3'-0" x 6'-8"	1 3/4"	HM.	PAINT	HM.	PAINT	HM.	PAINT	E	FLUSH & FURNACE CLOS.
7	2'-8" x 6'-8"	1 3/4"	HM.	PAINT	HM.	PAINT	HM.	PAINT	E	UNDERCUT DOOR 1" FOR AIR
8	2'-8" x 6'-8"	1 3/4"	HM.	PAINT	HM.	PAINT	HM.	PAINT	E	UNDERCUT DOOR 1" FOR AIR
9	3'-0" x 6'-8"	1 3/4"	HM.	PAINT	HM.	PAINT	HM.	PAINT	E	20 MIN.
10	3'-0" x 6'-8"	1 3/4"	HM.	PAINT	HM.	PAINT	HM.	PAINT	E	20 MIN.
11	3'-0" x 6'-8"	1 3/4"	HM.	PAINT	HM.	PAINT	HM.	PAINT	E	20 MIN.
12	3'-0" x 6'-8"	1 3/4"	HM.	PAINT	HM.	PAINT	HM.	PAINT	E	20 MIN.
13	2'-8" x 6'-8"	1 3/4"	HM.	PAINT	HM.	PAINT	HM.	PAINT	E	16" x 16" NO VISION MTL LOUVER, 2" x 36" 88 KICKPLATES
14	2'-8" x 6'-8"	1 3/4"	HM.	PAINT	HM.	PAINT	HM.	PAINT	E	16" x 16" NO VISION MTL LOUVER, 2" x 36" 88 KICKPLATES
15	2'-8" x 6'-8"	1 3/4"	HM.	PAINT	HM.	PAINT	HM.	PAINT	E	
16	2'-8" x 6'-8"	1 3/4"	HM.	PAINT	HM.	PAINT	HM.	PAINT	E	
17	3'-0" x 6'-8"	1 3/4"	HM.	PAINT	HM.	PAINT	ALUM.	ALUM.	C	VISION LITE EXT. DR/FRAME
18	3'-0" x 6'-8"	1 3/4"	HM.	PAINT	HM.	PAINT	ALUM.	ALUM.	C	VISION LITE EXT. DR/FRAME
19	DBL 2'-0" x 6'-8"	1 3/4"	HM.	PAINT	HM.	PAINT	HM.	PAINT	E	EXISTING BLDG & JANITORS
20	3'-0" x 6'-8"	1 3/4"	HM.	PAINT	HM.	PAINT	HM.	PAINT	E	20 MIN.

FF PRE-FINISHED WOOD OR MTL SOLID CORE WOOD FACED
 HM HOLLOW CORE WOOD FACED
 HM HOLLOW METAL DOOR OR FRAME
 DM DARK BRONZE ANODIZED ALUM.
 PAINT SHOP PRIME/FIELD PAINT
 STAIN FIELD STAIN URETHANE SEALANT OR WOOD
 NOTE: EXIST DOORS SHALL BE OPENABLE FROM THE INSIDE WITHOUT THE USE OF A KEY OR ANY SPECIAL KNOWLEDGE OR EFFORT. (SEE SPECS)

WINDOW SCHEDULE

WINDOW MARK	DIMENSIONS	SPECIFICATIONS	REMARKS
A	2'-11 1/2" x 2'-4 1/2"	ANDERSEN CSEMT	1
B	10'-0" x 10'-0"	KAINEER FIXED	481T
BI	10'-0" x 10'-0"	KAINEER FIXED	482
C	1'-11 1/2" x 1'-11 1/2"	ANDERSEN CSEMT	3
D	4'-8" x 4'-8"	ANDERSEN CSEMT	1
E	3'-4 1/2" x 2'-11 1/2"	ANDERSEN FIXED	2
F	1'-0" x 1'-0"	CUSTOM FIXED	1
G	4'-0" x 4'-0"	CUSTOM FIXED	1

G.C. TO VERIFY W/MANUF ALL ROUGH OPENINGS & WINDOW ARRANGEMENTS.
 STAIN: FIELD STAIN TO MATCH DR/ URETHANE SEALANT MATCH. MATCH FINISH TO EXTG BLDG.
 ALL GLASS DOORS & SIDELITES TO MEET TEMPERED SAFETY REQUIREMENTS PER OBC SECTION 2406.1

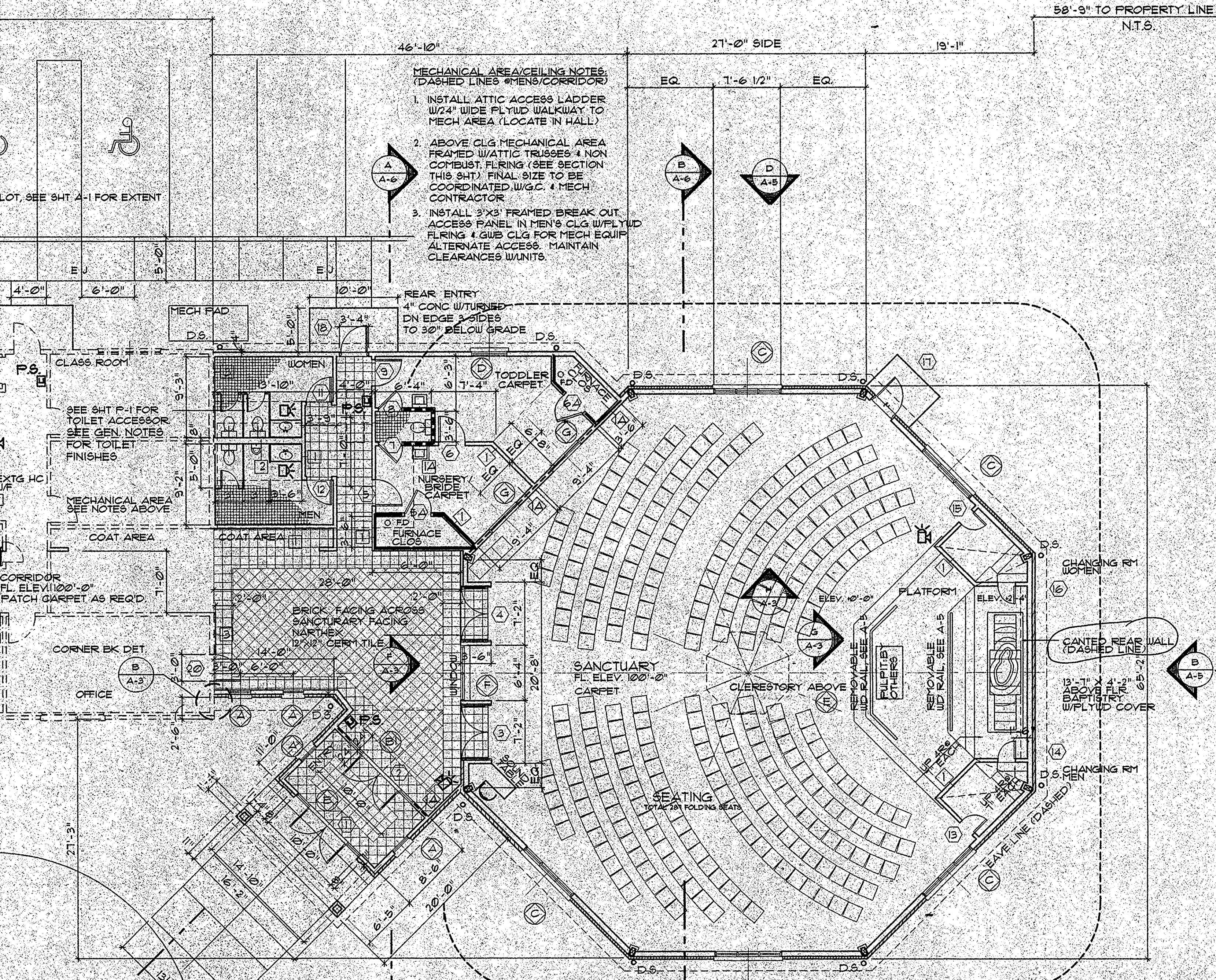

HARDWARE SETS

ITEM	MANUF	SPECIFICATION/PART NUMBER
HARDWARE SET A (EXTERIOR EXIT) PUSH/FULL HANDLES CLOSER THRESHOLD WEATHERSTRIP DEAD BOLT 3 PAIR BUTTS PANIC BAR CYLINDER LOCK	KAINEER DORMA ZERO SCHLAGE KAINEER VON DUPIN KAINEER	692 SERIES (HANDICAP ACCESS) ALUM (HANDICAP ACCESS) NEOPRENE DOUBLE CYLINDER 452 SERIES STANDARD BRONZE SERIES 38 SURFACE MTD WITH INTERIOR THUMB TURN #42" AFF.
HARDWARE SET B (INTERIOR EXIT) PUSH/FULL PLATES CLOSER 3 PAIR BUTTS NO CYLINDER LOCK ALLOWED ON SET 'B' PER OBC	KAINEER DORMA KAINEER	452 SERIES STANDARD BRONZE 652 SERIES (HANDICAP ACCESS) 452 SERIES STANDARD BRONZE
HARDWARE SET C (EMERG. EXIT) CLOSER THRESHOLD WEATHERSTRIP 1 1/2 PAIR BUTTS PANIC BAR	DORMA ZERO HAGER VON DUPIN	692 SERIES (HANDICAP ACCESS) ALUM (HANDICAP ACCESS) NEOPRENE BB219 U532 4 1/2" x 4 1/2" SERIES 38 SURFACE MTD
HARDWARE SET D (TOILET) PUSH/FULL PLATES (2) CLOSER 1 1/2 PAIR BUTTS 18" HT KICKPLATE (2)	HAGER DORMA HAGER	302 SERIES U532D 652 SERIES (HANDICAP ACCESS) BB219 U532 4 1/2" x 4 1/2" 192 SERIES U532D 18GA (BOTH SIDES)
HARDWARE SET E (OFFICE) LEVER CORRIDOR SET 1 1/2 PAIR BUTTS STOP	SCHLAGE HAGER	R4065 D13PD W/BEUTON LOCK BB219 U532 4 1/2" x 4 1/2" 24E

G.C. MUST SUBMIT ALTERNATES TO ARCHITECT FOR APPROVAL FOR ALL HARDWARE ITEMS.
 NOTE: EXTENTS OF NON COMBUSTIBLE FLIRING TO MEET REQUIREMENTS OF OBC ARTICLE 4 & NFPA 3.

425 TOTAL ADDITION SQ FOOTAGE MEN SANCTUARY & ENTRY
SCALE: 1/8" = 1'-0"

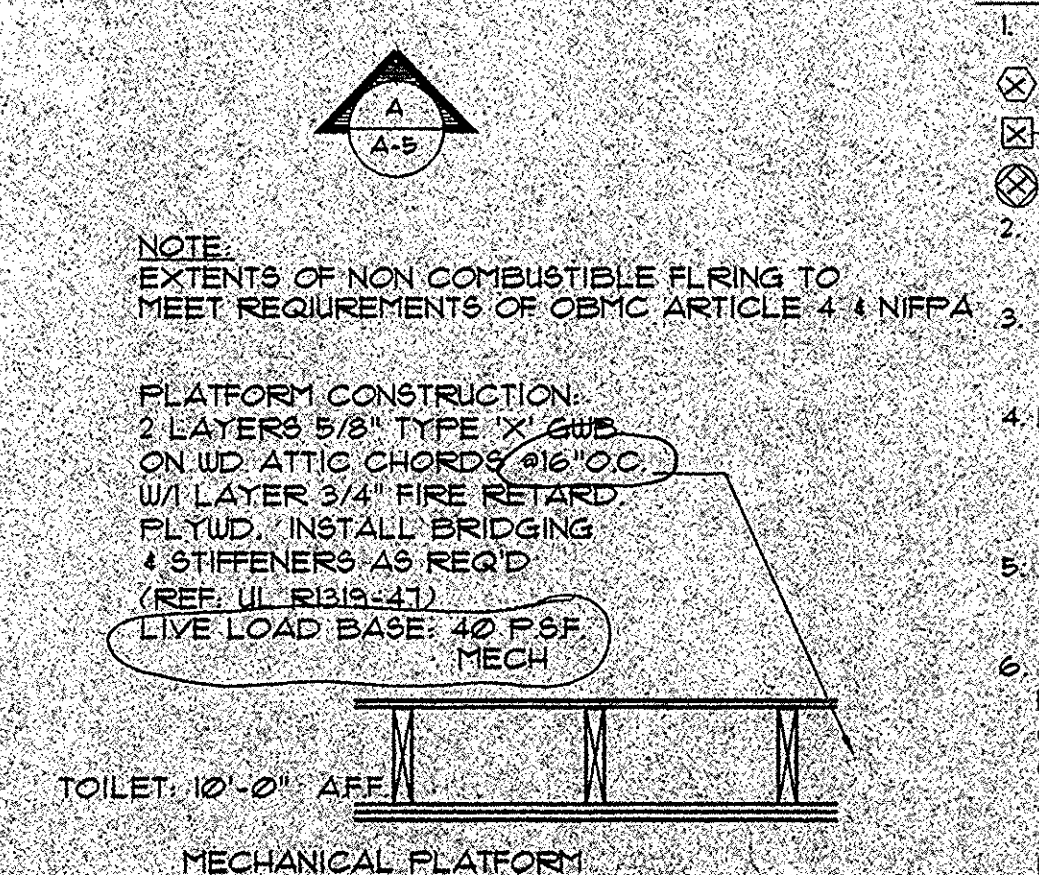

MECHANICAL PLATFORM SECTION
SCALE: 3/4" = 1'-0"

CONTRACTOR'S NOTE
THE GENERAL CONTRACTOR & PRE-ENG MANUFACTURER IS RESPONSIBLE TO PROVIDE COMPLETE FABRICATION AND STRUCTURAL DRAWINGS SHOWING DETAILS, CONNECTIONS, AND METHODS OF WATER-TIGHTENING THE ENVELOPE.

ENGINEER'S NOTE
PRE-ENGINEERED BLDG MANUFACTURER SHALL SUBMIT ALL DESIGN LOADS & CALCULATIONS. SUBMIT ALL ERECTION SECTIONS & DETAILS WITH ALL DRAWINGS TO BE SIGNED & SEALED BY ENGINEER/ARCHITECT RESPONSIBLE FOR DESIGN.

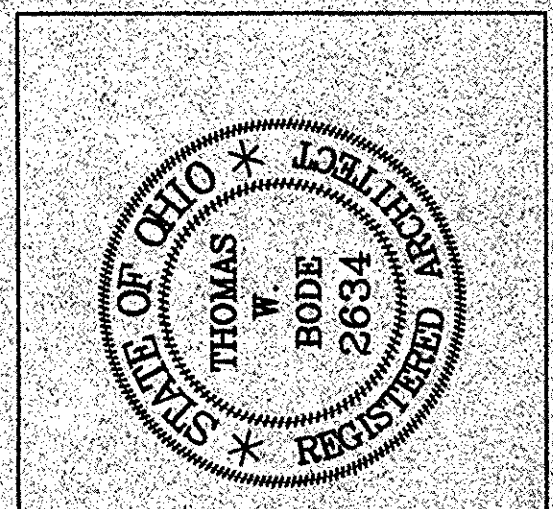

THOMAS W. BODE AND ASSOCIATES
ARCHITECTS, INC.
11524 MARKET STREET
P.O. BOX 341
NORTH LIMA, OHIO 44452
(216) 543-0001
COPYRIGHT ALL RIGHTS RESERVED

REVISIONS

DATE	REVISION	BY

CONTRACTOR SHALL VERIFY ALL DIMENSIONS & CONDITIONS AT THE BUILDING.

JULY 28, 1997

A CHURCH ADDITION FOR
IDAHO ROAD ALLIANCE CHURCH
250 IDAHO ROAD
AUSTINTOWN TOWN TWP
FLOOR PLAN

PROJECT NO. 96-45

A=3